

BEGA**84 258**

Surface floodlight



Project · Reference number

Date

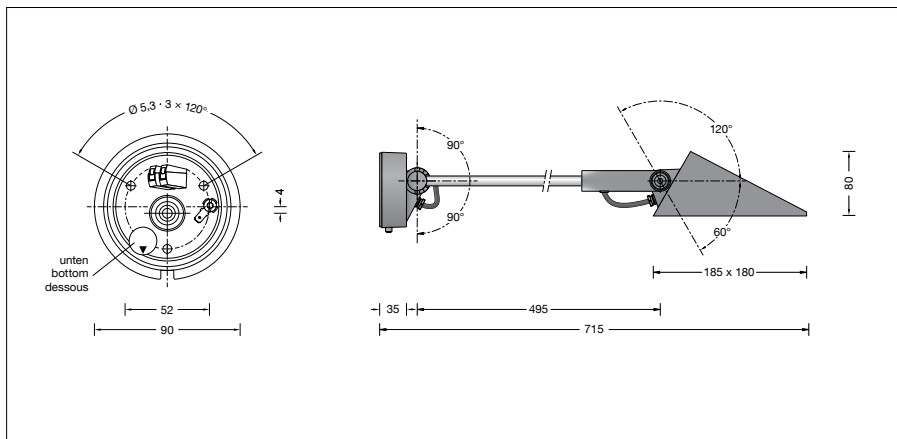

Product data sheet

Product description

Luminaire made of aluminium alloy, aluminium and stainless steel
 BEGA Unidure® coating technology
 Colour graphite or silver
 Safety glass
 Reflector made of pure anodised aluminium
 Rotation range surface floodlight 350°
 Swivel range of outrigger arm:
 Joint mounting box 0°-180° in steps of 22,5°
 Joint surface floodlight: -60°/+120° infinitely
 Mounting plate with 3 fixing holes \varnothing 5,3mm
 Angle 120° · Pitch circle \varnothing 52mm
 1 cable entry for mains supply cable up to \varnothing 10,5mm
 Connection terminal 2.5[□]
 Earth conductor connection
 Complies with flicker requirements in accordance with IEEE 1789,
 DIN IEC/TR 63158, DIN IEC/TR 61547-1
 LED power supply unit
 220-240 V \sim 0/50-60 Hz
 DC 176-276 V
 BEGA Thermal Control®
 Temporary thermal regulation to protect temperature-sensitive components without switching off the luminaire
 Safety class I
 Protection class IP 65
 Dust-tight and protection against water jets
 Impact strength IK07
 Protection against mechanical impacts < 2 joule
 – Safety mark
 – Conformity mark
 Weight: 2.0 kg
 This product contains light sources of energy efficiency class(es) D

Application

Surface floodlight with mounting box and outrigger arm for installation on ceilings and walls. With asymmetrical light distribution for illuminating wall-, ceiling-, ground surfaces or advertising boards.

Lamp

Module connected wattage	11.3 W
Luminaire connected wattage	13 W
Rated temperature	$t_a = 25^\circ\text{C}$
Ambient temperature	$t_{a\text{max}} = 50^\circ\text{C}$

84 258 K3

Module designation	LED-0590/930
Colour temperature	3000 K
Colour rendering index	CRI > 90
Module luminous flux	1770 lm
Luminaire luminous flux	1332 lm
Luminaire luminous efficiency	102,5 lm/W

84 258 K4

Module designation	LED-0590/940
Colour temperature	4000 K
Colour rendering index	CRI > 90
Module luminous flux	1840 lm
Luminaire luminous flux	1392 lm
Luminaire luminous efficiency	107,1 lm/W

Service life · Ambient temperature

Rated temperature $t_a = 25^\circ\text{C}$	
LED psu:	> 50,000 h
LED module:	> 200,000 h (L80 B50)
	100,000 h (L90 B50)

Ambient temperature max. $t_a = 50^\circ\text{C}$ (100 %)	
LED psu:	50,000 h
LED module:	160,000 h (L80 B50)

Lighting technology

Luminaire data for the DIALux lighting design program for outdoor lighting, street lighting and indoor lighting, as well as luminaire data in EULUMDAT and IES format are available on the BEGA website at www.bega.com.

BEGA Constant Optics®

BEGA Constant Optics® is an efficient optical system that is virtually impervious to wear and tear. The durable materials used, including glass, pure aluminium and silicone, show no effects of ageing, even under extreme conditions like high temperatures and UV radiation.

Inrush current

Inrush current: 16 A / 100 μs
 Maximum number of luminaires of this type per miniature circuit breaker:
 B 10A: 25 luminaires
 B 16A: 55 luminaires
 C 10A: 45 luminaires
 C 16A: 70 luminaires

Ratio of luminous flux

Luminous flux upper half-space	0 %
Luminous flux lower half-space	100 %

BUG rating according to IES TM-15-07:

1-0-0

CEN Flux Code according to EN 13032-2:
 44-83-98-100-100

Article No. 84 258

LED colour temperature optionally 3000K or 4000K

3000 K – Article number + **K3**

4000 K – Article number + **K4**

Colour graphite or silver
 graphite – article number
 silver – article number + **A**

Light distribution

